

Note: Some designs in this collection may have been created using unique special stitches and/or techniques. To preserve design integrity when rescaling or rotating designs in your software, always rescale or rotate designs using the handles directly on-screen.



OC85001
3.85 X 3.82 in.
97.79 X 97.03 mm
8,425 St.



OC85002
2.19 X 3.91 in.
55.63 X 99.31 mm
4,981 St.



OC85003
2.40 X 3.90 in.
60.96 X 99.06 mm
7,776 St.



OC85004
2.76 X 4.17 in.
70.10 X 105.92 mm
7,521 St.



OC85005
4.25 X 1.49 in.
107.95 X 37.85 mm
5,901 St. **S**



OC85006
2.62 X 2.80 in.
66.55 X 71.12 mm
4,647 St.



OC85007
2.66 X 2.66 in.
67.56 X 67.56 mm
6,505 St.

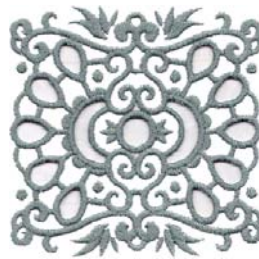

OC85008
3.79 X 3.76 in.
96.27 X 95.50 mm
15,832 St.



OC85009
3.81 X 2.08 in.
96.77 X 52.83 mm
6,285 St.



OC85010
2.20 X 2.21 in.
55.88 X 56.13 mm
4,076 St.



OC85011
3.91 X 1.40 in.
99.31 X 35.56 mm
6,029 St. **S**



OC85012
3.89 X 1.83 in.
98.81 X 46.48 mm
6,083 St.



OC85012_CWC (for use
with Bernina CutWork
Tool)
3.89 X 1.83 in.
98.81 X 46.48 mm
7,497 St.



OC85013
3.42 X 4.21 in.
86.87 X 106.93 mm
10,642 St.



OC85014
3.09 X 4.43 in.
78.49 X 112.52 mm
8,236 St.



OC85015
3.73 X 3.74 in.
94.74 X 95.00 mm
7,000 St.



OC85016
3.25 X 2.42 in.
82.55 X 61.47 mm
5,553 St.



OC85017
2.89 X 2.89 in.
73.41 X 73.41 mm
9,114 St.



OC85018
2.11 X 3.04 in.
53.59 X 77.22 mm
4,361 St.



OC85019
3.81 X 2.79 in.
96.77 X 70.87 mm
6,778 St.

⌘ Design contains a loose fill.
⚙ Some white areas shown are not stitched.

L Design is larger than 5" (127 mm) in either direction.
S Design is smaller than 1.5" (38.1 mm) in either direction.

Note: Some designs in this collection may have been created using unique special stitches and/or techniques. To preserve design integrity when rescaling or rotating designs in your software, always rescale or rotate designs using the handles directly on-screen.



OC85019_CWC (for use with Bernina CutWork Tool)
3.81 X 2.79 in.
96.77 X 70.87 mm
8,534 St.



OC85020
2.88 X 3.34 in.
73.15 X 84.84 mm
7,154 St.



OC85021
1.74 X 1.74 in.
44.20 X 44.20 mm
2,880 St.



OC85022
3.85 X 3.85 in.
97.79 X 97.79 mm
10,540 St.



OC85023
3.90 X 2.64 in.
99.06 X 67.06 mm
9,745 St.



OC85024
3.07 X 3.58 in.
77.98 X 90.93 mm
7,569 St.



OC85024_CWC (for use with Bernina CutWork Tool)
3.07 X 3.58 in.
77.98 X 90.93 mm
9,242 St.



OC85025
2.71 X 2.63 in.
68.83 X 66.80 mm
4,649 St.



OC85026
2.81 X 2.77 in.
71.37 X 70.36 mm
6,846 St.



OC85027
3.62 X 2.81 in.
91.95 X 71.37 mm
6,444 St.



OC85028
3.78 X 3.01 in.
96.01 X 76.45 mm
8,156 St.



OC85028_CWC (for use with Bernina CutWork Tool)
3.78 X 3.01 in.
96.01 X 76.45 mm
9,449 St.



OC85029
2.99 X 5.39 in.
75.95 X 136.91 mm
7,611 St. L



OC85030
2.78 X 4.18 in.
70.61 X 106.17 mm
7,638 St.



OC85031
6.04 X 3.50 in.
153.42 X 88.90 mm
17,281 St. L



OC85032
6.77 X 3.05 in.
171.96 X 77.47 mm
16,951 St. L



OC85033
1.73 X 2.55 in.
43.94 X 64.77 mm
3,061 St.



OC85034
2.54 X 1.86 in.
64.52 X 47.24 mm
3,470 St.



OC85034_CWC (for use with Bernina CutWork Tool)
2.54 X 1.86 in.
64.52 X 47.24 mm
4,491 St.



OC85035
4.42 X 2.30 in.
112.27 X 58.42 mm
6,397 St.

☞ Design contains a loose fill.
⚙ Some white areas shown are not stitched.

L Design is larger than 5" (127 mm) in either direction.
S Design is smaller than 1.5" (38.1 mm) in either direction.

Note: Some designs in this collection may have been created using unique special stitches and/or techniques. To preserve design integrity when rescaling or rotating designs in your software, always rescale or rotate designs using the handles directly on-screen.



OC85036
2.45 X 3.73 in.
62.23 X 94.74 mm
4,382 St.



OC85037
2.41 X 3.41 in.
61.21 X 86.61 mm
3,751 St.



OC85038
2.91 X 2.68 in.
73.91 X 68.07 mm
4,094 St.



**OC85038_CWC (for use
with Bernina CutWork
Tool)**
2.91 X 2.68 in.
73.91 X 68.07 mm
4,543 St.

⌘ Design contains a loose fill.
⚙ Some white areas shown are not stitched.

L Design is larger than 5" (127 mm) in either direction.
S Design is smaller than 1.5" (38.1 mm) in either direction.



HERITAGE CREATIONS: CUTWORK

PACK 48500 • 38 DESIGNS

Listings below indicate color sample, stitching order and suggested thread color number, Isacord, Yenmet or YLI Variegated threads.

OC85001

- 1. Cutwork Guide Stitch.....0142
- 2. Design0142

OC85002

- 1. Cutwork Guide Stitch.....0142
- 2. Design0142

OC85003

- 1. Cutwork Guide Stitch.....0142
- 2. Design0142

OC85004

- 1. Cutwork Guide Stitch.....0142
- 2. Design0142

OC85005

- 1. Cutwork Guide Stitch.....0142
- 2. Design0142

OC85006

- 1. Cutwork Guide Stitch.....0142
- 2. Design0142

OC85007

- 1. Cutwork Guide Stitch.....0142
- 2. Design0142

OC85008

- 1. Cutwork Guide Stitch.....0142
- 2. Design0142

OC85009

- 1. Cutwork Guide Stitch.....0142
- 2. Design0142

OC85010

- 1. Cutwork Guide Stitch.....1172
- 2. Design1172

OC85011

- 1. Cutwork Guide Stitch.....1172
- 2. Design1172

OC85012

- 1. Cutwork Guide Stitch.....1172
- 2. Design1172

OC85012_CWC (for use

with Bernina

CutWork Tool)

- 1. Cutwork Guide Stitch.....0020
- 2. Cut 1.....0000
- 3. Cut 2.....0000
- 4. Cut 3.....0000
- 5. Cut 4.....0000
- 6. Design1172

OC85013

- 1. Cutwork Guide Stitch.....1172
- 2. Design1172

OC85014

- 1. Cutwork Guide Stitch.....1172
- 2. Design1172

OC85015

- 1. Cutwork Guide Stitch.....1172
- 2. Design1172

OC85016

- 1. Cutwork Guide Stitch.....1172
- 2. Design1172

OC85017

- 1. Cutwork Guide Stitch.....1172
- 2. Design1172

OC85018

- 1. Cutwork Guide Stitch.....0874
- 2. Design0874

OC85019

- 1. Cutwork Guide Stitch.....0874
- 2. Design0874

OC85019_CWC (for use

with Bernina

CutWork Tool)

- 1. Cutwork Guide Stitch.....0020
- 2. Cut 1.....0000
- 3. Cut 2.....0000
- 4. Cut 3.....0000
- 5. Cut 4.....0000
- 6. Design0874

OC85020

- 1. Cutwork Guide Stitch.....0874
- 2. Design0874

OC85021

- 1. Cutwork Guide Stitch.....0874
- 2. Design0874

OC85022

- 1. Cutwork Guide Stitch.....0874
- 2. Design0874

OC85023

- 1. Cutwork Guide Stitch.....0874
- 2. Design0874

OC85024

- 1. Cutwork Guide Stitch.....2166
- 2. Design2166

OC85024_CWC (for use

with Bernina

CutWork Tool)

- 1. Cutwork Guide Stitch.....0020
- 2. Cut 1.....0000
- 3. Cut 2.....0000
- 4. Cut 3.....0000
- 5. Cut 4.....0000
- 6. Design2166

OC85025

- 1. Cutwork Guide Stitch.....2166
- 2. Design2166

OC85026

- 1. Cutwork Guide Stitch.....2166
- 2. Design2166

OC85027

- 1. Cutwork Guide Stitch.....2166
- 2. Design2166

OC85028

- 1. Cutwork Guide Stitch.....2166
- 2. Design2166

OC85028_CWC (for use

with Bernina

CutWork Tool)

- 1. Cutwork Guide Stitch.....0020
- 2. Cut 1.....0000
- 3. Cut 2.....0000
- 4. Cut 3.....0000
- 5. Cut 4.....0000
- 6. Design2166

OC85029

- 1. Cutwork Guide Stitch.....2166
- 2. Design2166

OC85030

- 1. Cutwork Guide Stitch.....2166
- 2. Design2166

OC85031

- 1. Cutwork Guide Stitch.....2166
- 2. Design2166

OC85032

- 1. Cutwork Guide Stitch.....2166
- 2. Design2166

OC85033

- 1. Cutwork Guide Stitch.....5050
- 2. Design5050

OC85034

- 1. Cutwork Guide Stitch.....5050
- 2. Design5050

OC85034_CWC (for use

with Bernina

CutWork Tool)

- 1. Cutwork Guide Stitch.....0020
- 2. Cut 1.....0000
- 3. Cut 2.....0000
- 4. Cut 3.....0000
- 5. Cut 4.....0000
- 6. Design5050

OC85035

- 1. Cutwork Guide Stitch.....5050
- 2. Design5050

OC85036

- 1. Cutwork Guide Stitch.....5050
- 2. Design5050

OC85037

- 1. Cutwork Guide Stitch.....5050
- 2. Design5050

OC85038

- 1. Cutwork Guide Stitch.....5050
- 2. Design5050

OC85038_CWC (for use

with Bernina

CutWork Tool)

- 1. Cutwork Guide Stitch.....0020
- 2. Cut 1.....0000
- 3. Cut 2.....0000
- 4. Cut 3.....0000
- 5. Cut 4.....0000
- 6. Design5050

OESD™ Using the Bernina® CutWork Tool

SUPPLIES

- OESD AquaMesh Water Soluble Stabilizer
- OESD AquaMesh Plus Water Soluble Stabilizer
- 101 Temporary Spray Adhesive
- Isacord Polyester Embroidery Thread
- Bernina® CutWork Tool
- Embroidery foot #44 or #15

PREPARE FABRIC

- Starch fabric 2-3 times following manufacturer's instructions.
- Fabric to be cut should be crisp.
- Spray one hoop sized piece of AquaMesh Stabilizer and adhere it to the wrong side of your fabric.
- Hoop stabilizer and fabric.

EMBROIDER AND CUT

- Send desired design to the embroidery machine (designs enhanced to work with the CutWork tool will end in CWC).
- Replace normal stitch plate with the CutWork stitch plate.
- Attach the hoop to the machine.
- Stitch the design as normal until the machine shows Cut. **PHOTO 1**
- When the machine calls for cut 1, 2, 3 or 4 you must replace embroidery foot with foot #44 and replace your embroidery needle with the CutWork tool (If you do not have foot #44 you can leave foot #15 on the machine). **PHOTO 02**
- Unthread the machine.
- Follow the "thread changes" on your machine screen and turn the dial on the CutWork tool as required.
- After cuts are complete, remove hoop from machine but do not remove the fabric from the hoop.
- Gently remove any cut fabric piece, trimming any thread that may have not been cut completely.
- Apply a piece of AquaMesh Plus Stabilizer over the cut pieces on the backside of the hoop, making sure to completely cover cut areas. **PHOTO 03**
- When the machine calls for threads again replace the needle and foot, rethread the machine and stitch as normal.
- Repeat as required, until design is completed. **PHOTO 04**
- Remove hoop from machine and fabric and stabilizer from hoop.
- Carefully cut away excess stabilizer.
- Follow instructions printed on stabilizer packaging to remove remaining stabilizer.

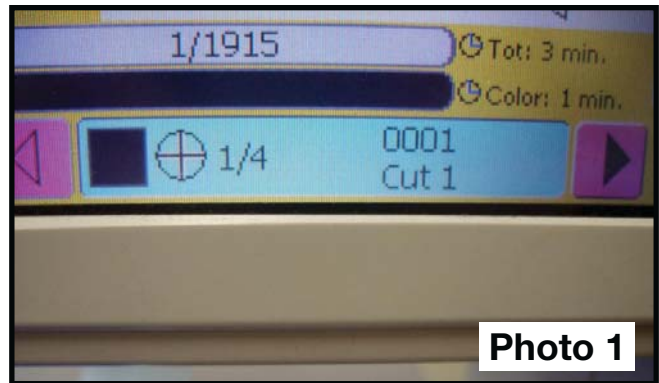

SUPPLIES:

- Fabric
- Any firmly woven high quality fabric.
- Thread
- Isacord Polyester Embroidery Thread
- Stabilizer
- OESD Badgemaster or OESD Aqua Mesh Stabilizer
- Optional Notions
- Embroiders' Wand
- 505 Temporary Adhesive Spray

INSTRUCTIONS:

- Lightly spray the top of a hoop sized piece of OESD Badgemaster or AquaMesh Stabilizer with 505 Temporary Adhesive Spray.
- Place the sprayed stabilizer onto the wrong side of the fabric in the design area and hoop.
- Place the hoop on the machine and begin stitching the design.
- AFTER the "cutwork guide stitch" has been stitched, remove the hoop from the machine. DO NOT remove the fabric from the hoop. **PICTURE 1**
- Use the sharp point of an Embroidery Wand to gently pull the fabric apart from the stabilizer. Any enclosed area that is created by the first color of the design can be trimmed away to create the open work. **PICTURE 2**
- Use a small sharp pair of scissors to clip away ONLY the fabric inside the guide stitches. Leave the stabilizer intact.
- Place the hoop on the machine again and continue stitching the remainder of the embroidery design.

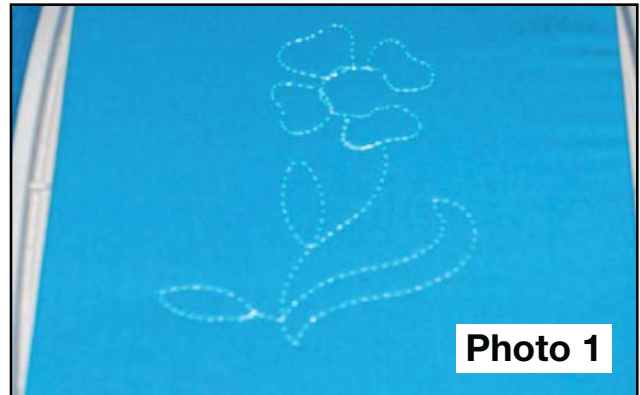

Photo 1

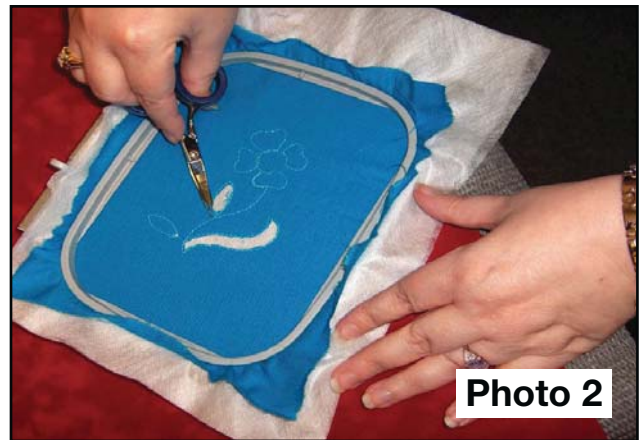

Photo 2

Designs shown are for instruction only.