

Note: Some designs in this collection may have been created using unique special stitches and/or techniques. To preserve design integrity when rescaling or rotating designs in your software, always rescale or rotate designs using the handles directly on-screen.

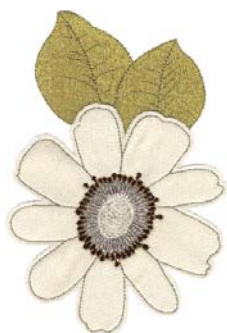

**CC05101**  
4.89 X 7.24 in.  
124.21 X 183.90 mm  
18,491 St. **L**



**CC05102**  
5.00 X 7.32 in.  
127.00 X 185.93 mm  
20,226 St. **L**



**CC05103**  
3.41 X 5.03 in.  
86.61 X 127.76 mm  
12,821 St. **L**



**CC05104**  
2.96 X 4.36 in.  
75.18 X 110.74 mm  
8,609 St.



**CC05105**  
3.41 X 3.63 in.  
86.61 X 92.20 mm  
6,831 St.



**CC05106**  
2.82 X 2.99 in.  
71.63 X 75.95 mm  
4,879 St.



**CC05107**  
2.95 X 2.71 in.  
74.93 X 68.83 mm  
3,402 St.



**CC05108**  
5.00 X 5.30 in.  
127.00 X 134.62 mm  
10,447 St. **L**



**CC05109**  
4.70 X 4.97 in.  
119.38 X 126.24 mm  
8,872 St.



**CC05110**  
4.40 X 4.06 in.  
111.76 X 103.12 mm  
5,139 St.



**CC05111**  
2.30 X 3.12 in.  
58.42 X 79.25 mm  
1,719 St.



**CC05112**  
2.19 X 3.00 in.  
55.63 X 76.20 mm  
852 St.

⌘ Design contains a loose fill.  
⚙ Some white areas shown are not stitched.

**L** Design is larger than 5" (127 mm) in either direction.  
**S** Design is smaller than 1.5" (38.1 mm) in either direction.

Note: Some designs in this collection may have been created using unique special stitches and/or techniques. To preserve design integrity when rescaling or rotating designs in your software, always rescale or rotate designs using the handles directly on-screen.



**CC05113**  
1.41 X 1.91 in.  
35.81 X 48.51 mm  
1,057 St. **S**



**CC05114**  
1.31 X 1.80 in.  
33.27 X 45.72 mm  
519 St. **S**



**CC05115**  
5.36 X 8.24 in.  
136.14 X 209.30 mm  
2,393 St. **L**



**CC05116**  
5.36 X 8.24 in.  
136.14 X 209.30 mm  
7,054 St. **L**

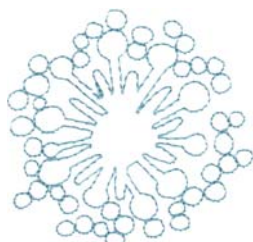

**CC05117**  
1.75 X 1.74 in.  
44.45 X 44.20 mm  
780 St.

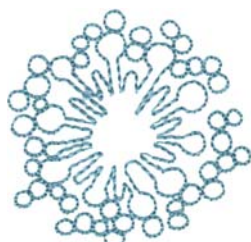

**CC05118**  
1.75 X 1.74 in.  
44.45 X 44.20 mm  
2,295 St.



**CC05119**  
1.75 X 1.67 in.  
44.45 X 42.42 mm  
870 St.



**CC05120**  
1.75 X 1.67 in.  
44.45 X 42.42 mm  
2,315 St.



**CC05121**  
1.86 X 4.77 in.  
47.24 X 121.16 mm  
2,573 St.



**CC05122**  
.57 X 7.00 in.  
14.48 X 177.80 mm  
3,886 St. **L S**



**CC05123**  
.94 X 7.00 in.  
23.88 X 177.80 mm  
6,606 St. **L S**

⌘ Design contains a loose fill.  
⚙ Some white areas shown are not stitched.

**L** Design is larger than 5" (127 mm) in either direction.  
**S** Design is smaller than 1.5" (38.1 mm) in either direction.



# HABITAT BY MICHELE D'AMORE

PACK 61051 • 23 DESIGNS

Listings below indicate color sample, stitching order and suggested thread color number in Isacord, YLI Fine Metallic, Yenmet or YLI Variegated threads.

**CC05101**

1. Leaves	0352
2. Leaves Outlines	0453
3. Appliqué Placement Stitch	0020
4. Appliqué Tackdown	4174
5. Green in Flower Center	5552
6. White in Flower Center	0670
7. Green Swirl in Flower Center	0453
8. Seeds	1366
9. Flower Center Highlight	0670
10. Seeds Outlines	0352

**CC05102**

1. Leaves	0352
2. Leaves Outlines	0453
3. Appliqué Placement Stitch	0020
4. Appliqué Tackdown & Cover Stitch	5552
5. Green in Flower Center	0352
6. White in Flower Center	0670
7. Brown Details in Flower Center	1366
8. Seeds	4625
9. Seeds Outlines	0453

**CC05103**

1. Leaves	0352
2. Leaves Outlines	0453
3. Appliqué Placement Stitch	0020
4. Appliqué Tackdown & Cover Stitch	5552
5. Green in Flower Center	0352
6. White in Flower Center	0670
7. Black Swirl in Flower Center	0020
8. Seeds	1366
9. Flower Center Highlight	0670
10. Seeds Outlines	0352

**CC05104**

1. Leaves	0352
2. Leaves Outlines	0453
3. Appliqué Placement Stitch	0020
4. Appliqué Tackdown	5552
5. Green in Flower Center	0352
6. White in Flower Center	0670
7. Brown Details in Flower Center	1366
8. Seeds	4625
9. Seeds Outlines	0453

**CC05105**

1. Appliqué Placement Stitch	0020
2. Appliqué Tackdown & Cover Stitch	5552
3. Green in Flower Center	0352
4. White in Flower Center	0670
5. Black Swirl in Flower Center	0020
6. Seeds	1366
7. Flower Center Highlight	0670
8. Seeds Outlines	0352

**CC05106**

1. Appliqué Placement Stitch	0020
2. Appliqué Tackdown & Cover Stitch	4174
3. Green in Flower Center	5552
4. White in Flower Center	0670
5. Dark Green Details in Flower Center	4625
6. Seeds	0352
7. Seeds Outlines	1366

**CC05107**

1. Appliqué Placement Stitch	0020
2. Appliqué Tackdown	4174
3. Green in Flower Center	5552
4. White in Flower Center	0670
5. Light Green in Flower Center	0453
6. Seeds	4625
7. Flower Center Highlights	0670
8. Seeds Outlines	0352

**CC05108**

1. Appliqué Placement Stitch	0020
2. Appliqué Tackdown & Cover Stitch	4174
3. Green in Flower Center	5552
4. White in Flower Center	0670
5. Green Swirl in Flower Center	0453
6. Seeds	1366
7. Flower Center Highlight	0670
8. Seeds Outlines	0352

**CC05109**

1. Appliqué Placement Stitch	0020
2. Appliqué Tackdown & Cover Stitch	4174
3. Green in Flower Center	5552
4. White in Flower Center	0670
5. Black Details in Flower Center	0020
6. Seeds	1366
7. Seeds Outlines	0453

**CC05110**

1. Appliqué Placement Stitch	0020
2. Appliqué Tackdown	5552
3. Green in Flower Center	0352
4. White in Flower Center	0670
5. Green in Flower Center	0453
6. Seeds	4625
7. White Details in Flower Center & Seeds Outlines	0670

**CC05111**

1. Appliqué Placement Stitch	0020
2. Appliqué Tackdown & Cover Stitch	0453

**CC05112**

1. Appliqué Placement Stitch	0020
2. Appliqué Tackdown & Details	0453

**CC05113**

1. Appliqué Placement Stitch	0020
2. Appliqué Tackdown & Cover Stitch	0453

**CC05114**

1. Appliqué Placement Stitch	0020
2. Appliqué Tackdown & Details	0453

**CC05115**

1. Single Color Design	0453
------------------------	------

**CC05116**

1. Single Color Design	0453
------------------------	------

**CC05117**

1. Single Color Design	5050
------------------------	------

**CC05118**

1. Single Color Design	5050
------------------------	------

**CC05119**

1. Single Color Design	5050
------------------------	------

**CC05120**

1. Single Color Design	5050
------------------------	------

**CC05121**

1. Olive Green Vine & Leaves	0453
2. Brown Shading	1366
3. Light Aqua Leaves	4620
4. Olive Shading	0352
5. Khaki Green Shading	5552
6. Dark Aqua Shading	4625

**CC05122**

1. Aqua Details	4620
2. Brown Details	1366

**CC05123**

1. Olive Center	0352
2. Dark Olive Edges	0453

It is a violation of Copyright law to make and distribute copies of software or artwork.

Software is licensed to the original purchaser for use at one location. ©2011 Michele D'Amore for use in home embroidery. All rights reserved.

1. Print out the necessary pages from the PDF of the appliqué pattern(s).
2. Mark the right side of the pattern pieces so you'll know which direction to lay the pattern on the fabric.
3. Lightly spray the wrong side of the pattern pieces with temporary adhesive spray and allow it to set for a few minutes.
4. Place the pattern pieces on the right side of the fabric and carefully cut them out. **PHOTO 01**
5. Sew the guide stitch on your hooped fabric. **PHOTO 02**
6. With the paper still stuck to the right side of the appliqué fabric, spray the wrong side of the fabric with temporary spray adhesive.
7. Place the fabric inside the sewn guide stitch so that it matches the stitching line then remove the paper pattern. **PHOTO 03**
8. Sew the tackdown. **PHOTO 04**
9. Sew the remainder of the design and repeat for any remaining pieces. **PHOTO 05**

**NOTE:** The patterns are sized for the designs as they were made. If you resize the design, you will need to resize the pattern the same amount. You can print out the pattern at the normal size and then copy it on a copy machine at the changed size, i.e. resize the design to 80%, resize the printed pattern to 80%.

**TIP:** When printing the patterns, make sure that the “Fit to page” option is **UNCHECKED** in the Print Dialog Box. If this option is checked the printed patterns will not be actual size.

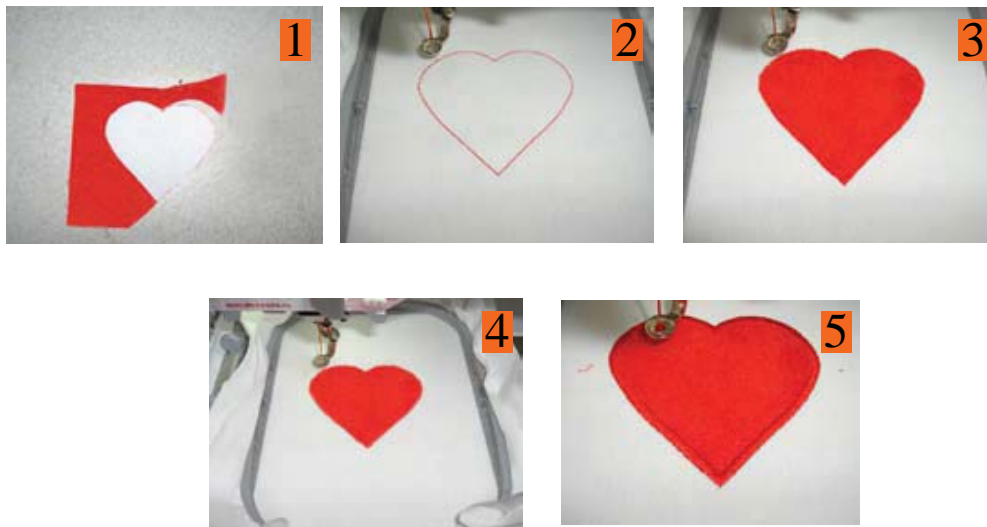

**NOTE:** Designs CC05105-CC05114 can become freestanding appliqué elements by simply stitching them on water soluble stabilizer. After stitching, cut away excess stabilizer and then wash the remaining stabilizer away following the manufacturers' instructions. Attach these freestanding appliqué elements to your projects by hand stitching, machine tacking or gluing in place.



# IMPORTANT:

When printing this document, the “Fit to page” option must be UNCHECKED or the “Page Scaling” option must be set to NONE depending on your printers options. If this option is set incorrectly, the prints will not work correctly as patterns because they will not print at actual size.

